

EXHIBIT E-1

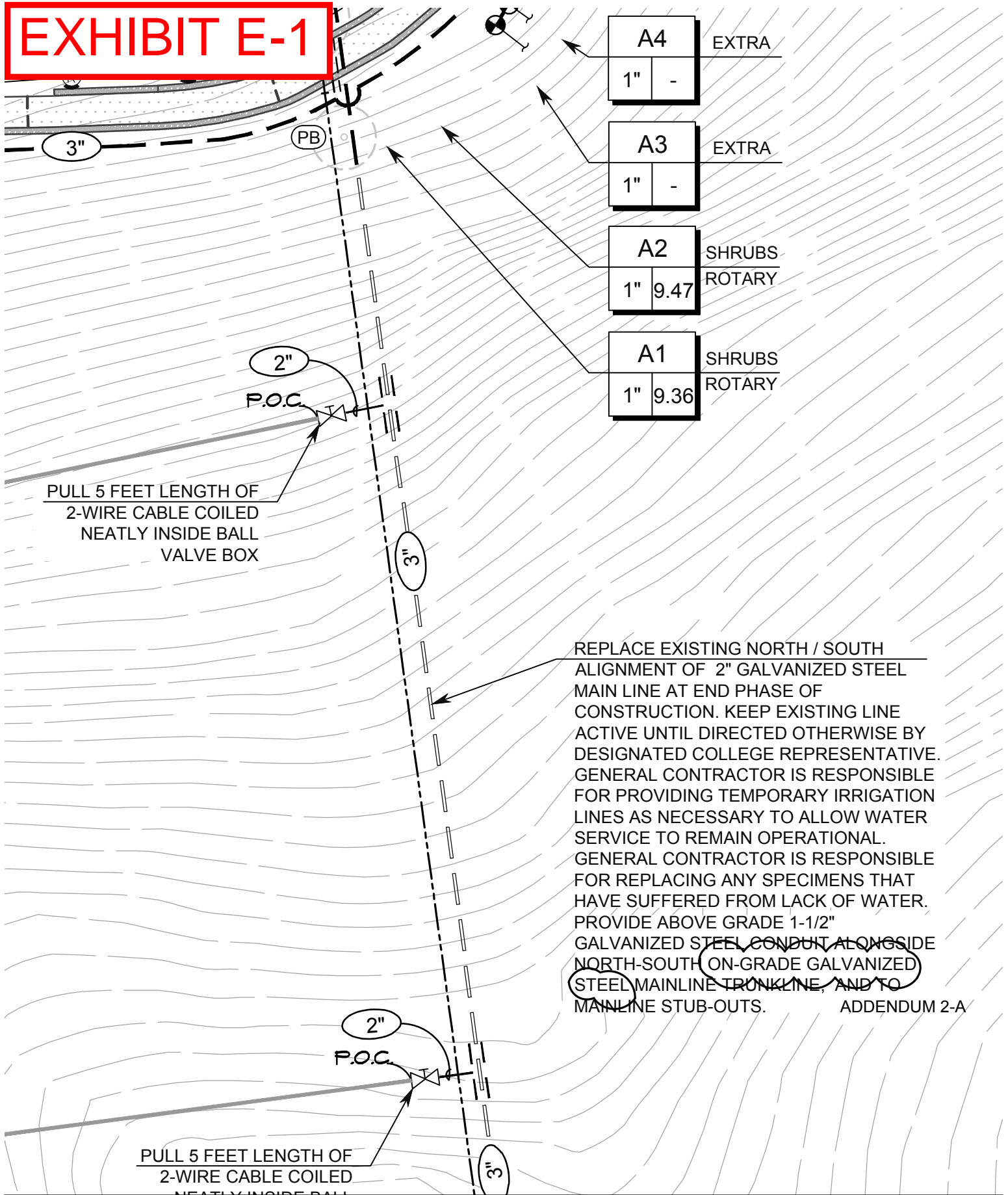
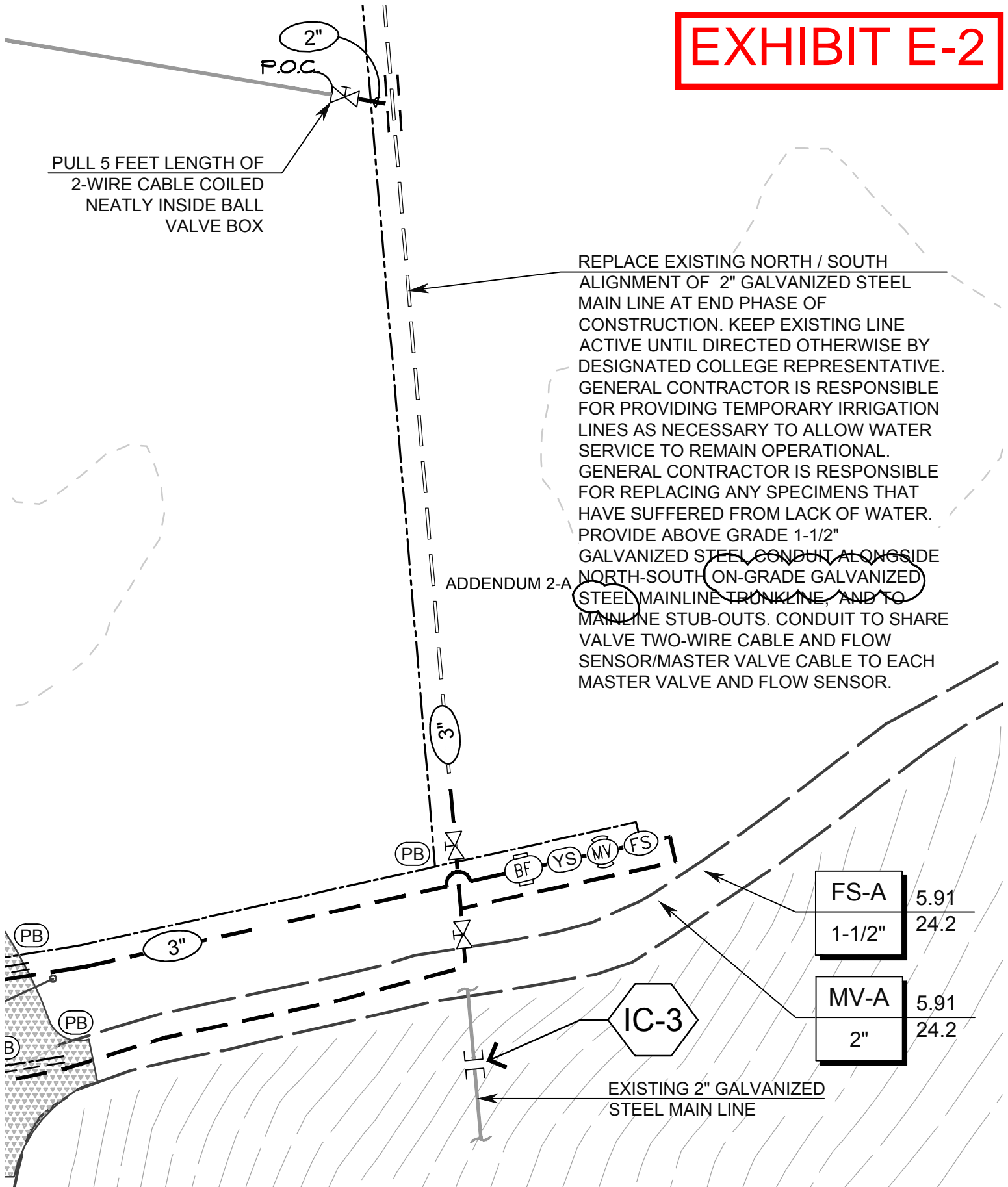

EXHIBIT E-2



PULL 5 FEET LENGTH OF
2-WIRE CABLE COILED
NEATLY INSIDE BALL
VALVE BOX

REPLACE EXISTING NORTH / SOUTH
ALIGNMENT OF 2" GALVANIZED STEEL
MAIN LINE AT END PHASE OF
CONSTRUCTION. KEEP EXISTING LINE
ACTIVE UNTIL DIRECTED OTHERWISE BY
DESIGNATED COLLEGE REPRESENTATIVE.
GENERAL CONTRACTOR IS RESPONSIBLE
FOR PROVIDING TEMPORARY IRRIGATION
LINES AS NECESSARY TO ALLOW WATER
SERVICE TO REMAIN OPERATIONAL.
GENERAL CONTRACTOR IS RESPONSIBLE
FOR REPLACING ANY SPECIMENS THAT
HAVE SUFFERED FROM LACK OF WATER.
PROVIDE ABOVE GRADE 1-1/2"
GALVANIZED STEEL CONDUIT ALONGSIDE
NORTH-SOUTH ON-GRADE GALVANIZED
STEEL MAINLINE TRUNKLINE, AND TO
MAINLINE STUB-OUTS. CONDUIT TO SHARE
VALVE TWO-WIRE CABLE AND FLOW
SENSOR/MASTER VALVE CABLE TO EACH
MASTER VALVE AND FLOW SENSOR.

ADDENDUM 2-A

FS-A	5.91
1-1/2"	24.2
MV-A	5.91
2"	24.2

EXISTING 2" GALVANIZED
STEEL MAIN LINE